

آزما صنعت گراد



نماینده انحصاری کمپانی **Mahr** آلمان

|
- 0 +



EXACTLY

DO YOU WANT TO AIM EVEN HIGHER? FOR THIS THERE IS DIGIMAR.



The latest information on DIGIMAR products can be found on our website:

www.mahr.com, WebCode 204

► | Mahr offers you a complete range of products in order for you to obtain the most reliable solution for all your measuring tasks. Whether it's simply scribing a work piece or complex measurements in two dimensions - Digimar Height Measuring Instruments guarantee a maximum of both flexibility and quality. Our motorized Height Measuring Instruments Digimar 817 CLM and 816 CL exceed all customer requirements; they are simple to operate, all the basic functions can be executed with a single key as well as offering a maximum of ease and accuracy.

▶ | Digimar. Height Measuring Instruments

Overview	
Digimar Height Measuring Instruments	2- 2
Motorized Height Measuring Instruments	
Digimar 817 CLM Quick Height	2- 4
High-End Height Measuring Instruments with 2D measurement and a statistics function	
Digimar 816 CL	2- 8
Height Measuring Instruments for use in the workshop and in production	
Accessories for 817 CLM and 816 CL	2-10
Manual Height Measuring Instruments	
Digimar M 814 N	2-16
With Cast Iron Base	
Digimar M 814 G	2-17
With Granite Table Plate	
Accessories for Digimar M 814	2-18
Height Measuring and Scribing Instrument	
Digimar 814 SR	2-19

Digimar. Height Measuring Instruments

OVERVIEW

	Digimar 817 CLM „Quick Height“		
			
	2-4	2-4	2-4
Catalog page			
Measuring range mm / <i>inch</i>	0-350 / 0-14"	0-600 / 0-24"	0-1000 / 0-40"
Application range up to mm / <i>inch</i>	520 / 20.47"	770 / 30.35"	1170 / 46.06"
Measuring error* in µm	1.8+L/600 (L in mm)	1.8+L/600 (L in mm)	1.8+L/600 (L in mm)
Quick Mode	●	●	●
1-D 	●	●	●
2-D 	●	●	●
Motorized measuring carriage	●	●	●
Scribing/marketing work pieces 			
Bore diameter 	●	●	●
Max-Min 	●	●	●
Tolerance monitoring 	●	●	●
Perpendicularity measurement 	●	●	●
Straightness measurement 	●	●	●
Angle calculation 	●	●	●
Statistics 	●	●	●
Measuring programs 	40	40	40
Temperature compensation 	●	●	●
Air bearings	●	●	●
Integrated USB memory 	●	●	●
Data interface	RS232	RS232	RS232
USB printer interface 	●	●	●
Order no.	4429010	4429011	4429012

* At 20°C in conjunction with a base plate in accordance to DIN 876/0 and a standard probe K6/51

Digimar 816 CL		Digimar M 814 N		Digimar M 814 G		Digimar 814 SR	
							
2-8	2-8	2-16	2-16	2-17	2-17	2-19	2-19
0-350 / 0-14"	0-600 / 0-24"	0-320 / 0-12"	0-620 / 0-24"	0-320 / 0-12"	0-620 / 0-24"	0-350 / 0-14"	0-600 / 0-24"
520 / 20.47"	770 / 30.31"	320 / 12.6"	620 / 24.4"	320 / 12.6"	620 / 24.4"	350 / 14"	600 / 24"
2.8+L/300 (L in mm)		20	30	20	30	40	50
•	•	•	•	•	•	•	•
•	•						
		•	•	•	•	•	•
•	•	•	•	•	•		
•	•	•	•	•	•		
		•	•	•	•		
1	1						
•	•						
•	•						
USB / RS232		Opto RS232		Opto RS232		USB / RS232 / Digimatic	
4429030	4429031	4426540	4426542	4426541	4426543	4426100	4426101

Digimar 817 CLM Quick Height

► | The new Height Measuring Instrument **Digimar 817 CLM** with the innovative Quick Mode. Highly accurate rapid measurements, a wide range of measuring and evaluation options and excellent operator comfort. | ◀

The best solution for all measuring tasks



Fast measurement per hand
Easy to operate due to the „Quick Mode“; an innovative solution from Mahr (patented).



Ill. 1. Move the measuring carriage by hand in the direction of the object to be measured.



Ill. 2. The motor starts, the measurement procedure will automatically be performed.

Measurement using the keypad (speed keys) on the base



Ideal in conjunction with the air bearings for large work pieces.

By using the keys that are integrated into the base; the operator can comfortably move the measuring carriage into the desired position and start a measurement. This eases measurement particularly when measuring large workpieces as these do not have to be moved into position. The operator can keep both hands on the measuring instrument (one hand on the key for the air bearing and other on the high-speed keys) and measure the workpiece in one run.



Highest accuracy and reliability

- Extremely accurate incremental measuring system with double reader head system, insensitive to the contamination of dirt
- Robust guide column, made from stainless steel
- Measuring head in precision ball bearings guide
- Temperature compensation with an integrated temperature sensor



Digimar 817 CLM



Ergonomic operating and display unit



- Large, back-lit display
- Self-explanatory guided operation with icons



- The display unit can be positioned freely with the swivel arm

Easy to operate all measurement functions with the function keys due to the clearly defined symbols.

Universal measurement possibilities

- Wide range of measurement functions in 1D or 2D
- Dynamic measurement functions with the analog display
- Automatic perpendicularity and straightness measurements (in conjunction with accessories)
- Automated measuring procedures (measurement programs)
- Auto function for chain measurements and distance measurements

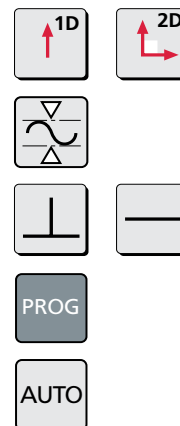

Extensive evaluation possibilities

- Transmit data to a PC via RS232 or USB (with an adapter) for example into MS Excel via the MarCom-Software
- Print measured values, statistics, etc. via a USB printer
- Save measured values in the integrated USB memory (will be recognized by a PC as an interchangeable disc drive) or on a USB dongle
- Broad range of statistical evaluations are available

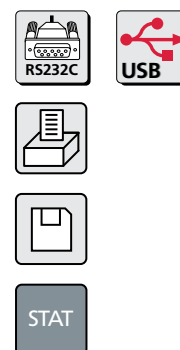

Height Measuring Instrument Digimar 817 CLM



See our brochure at
WebCode 12369



Features

Measuring system

- Excellent accuracy and reliability due to the optical incremental measurement system with the double reader head
- Dynamic probing system enabling high repeatability
- Air bearings system for light and smooth movement
- Precise measuring head on stainless steel guideways
- Motorised measuring carriage simplifies measurement runs
- Probe constant remains after the instrument is switched off
- Integrated rechargeable battery with a long operating time span for mains independent measurement
- Temperature compensation with an integrated temperature sensor

Operating and display unit

- Large and clearly defined function keys
- Easy to read background lit graphic LCD display
- Operator guidance with self-explanatory icons / pictograms
- Operator prompts and menus are available in several languages
- Possible to set additional zero points on a work piece
- RS232 and / or USB data output for further data processing
- Save measured data on the integrated USB memory or on a USB stick
- USB interface to connect a compatible USB printer
- Additional measuring instruments with Opto RS232-interface can be connected
- Secure the future due to software update potential
- Automatic Stand-by switch mode
- Selectable Auto-off function, without loss of measured values
- Supplied with:
Height Measuring Instrument incl. operating and display unit, Carrier 817h1, Probe K6/51, Setting block 817 eb, Operating instructions, Mains power adapter, USB cable and a Calibration certificate

Technical Data

Measuring range	mm / <i>inch</i>	350 / 14"	600 / 24"	1000 / 40"
Range of application	mm / <i>inch</i>	520 / 20.47"	770 / 30.31"	1170 / 46.06"
Resolution	mm <i>inch</i>	0.01 / 0.005 / 0.001 / 0.0005 / 0.0001 .001" / .0005" / .0001" / .00005" / .00001"		
Measuring error*	µm	(1.8 + L/600), L in mm		
Repeatability	µm	0.5 (plane) 1 (bore)		
Perpendicularity error (elect. adjusted)	µm	frontal ≤5	frontal ≤6	frontal ≤10
Operating time of rechargeable battery	h	up to 12		
Measuring force	N	1.0 ± 0.2		
Permissible relative air humidity	%	65 (non condensed)		
Working temperature	°C / °F	20 ± 1 / 68 ± 1.8		
Operating temperature	°C / °F	10 ... 40 / 50 ... 104		
3-point air cushion, height	µm	ca. 9		
Measuring system		incremental scale with optical reading		
Total height	mm / <i>inch</i>	741 / 29.17"	985 / 38.78"	1392 / 54.80"
Base area (L x W)	mm / <i>inch</i>	240 x 250 / 9.45" x 9.84"		
Weight	kg / lbs	25 / 55.15	30 / 66.14	35 / 77.16
Order no.		4429010	4429011	4429012

* At 20°C in conjunction with a base plate in accordance to DIN 876/0 and a standard probe K6/51

Height Measuring Instrument Digimar 817 CLM

Operating and display unit

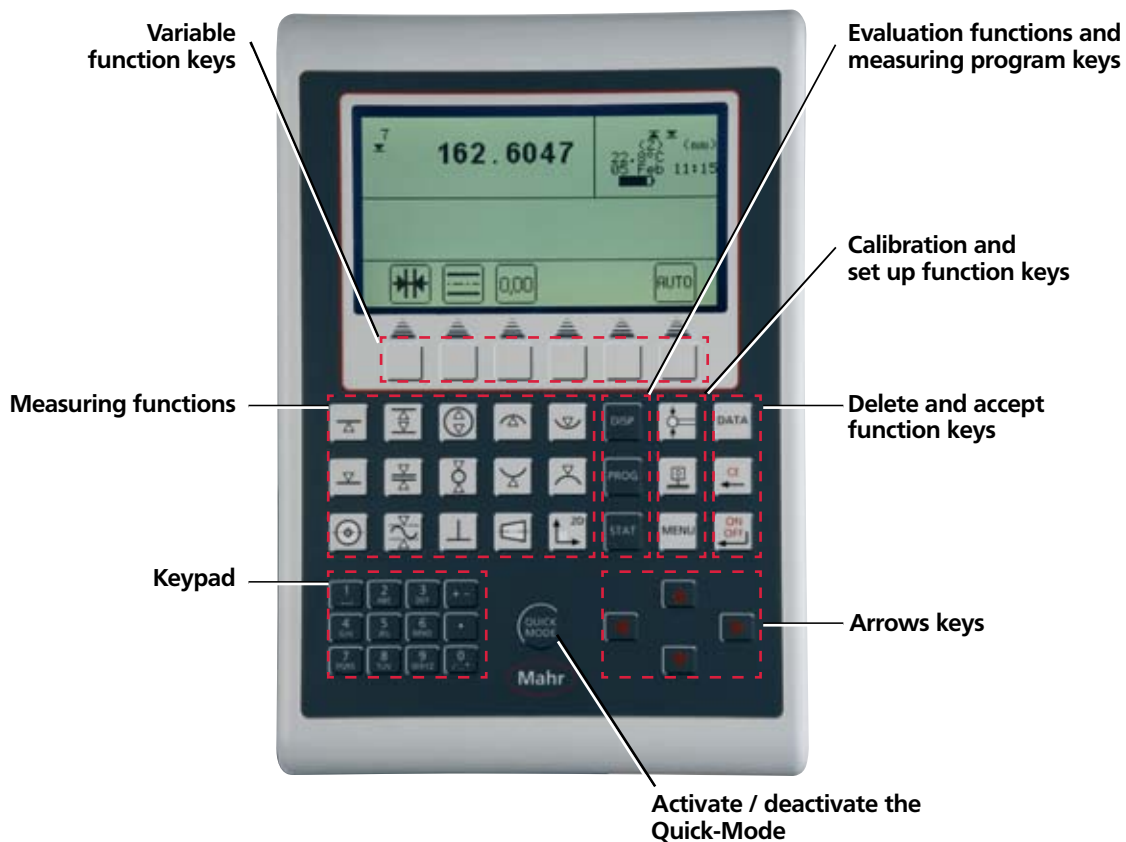

2D Operating and display unit

Operating and display unit

Measurement

One dimensional (1D)		●
Two dimensional (2D)		●
Measuring programs (automatic run)		40
Perpendicularity / straightness measurement		●
Flatness / parallel deviation (Max, Min)		●
Roundness / run-out deviation (Max-Min)		●
Measuring a taper		●

Evaluation

- Statistics		●
- Transmit measured values to a PC via RS232		●
- Print measured values and diagrams on a USB printer		●
- Print out statistical evaluations		●
- Save measured values on the integrated USB memory or on a USB dongle		●

Digimar 816 CL

► | The new Height Measuring Instrument **Digimar 816 CL**.

You want to obtain highly accurate measurement results without any complicated procedures? With the Digimar 816 CL you have the perfect partner for simple and accurate measurements both in the workshop or on the production line, just as you expect from Mahr! | ◀

User-friendly operation. . .

. . . due to the

- Clearly displayed measured values
- Self-explanatory operator guidance



The operating and display unit has a background illuminated display.

Precise measuring results. . .

. . . on the production line

- Robust design
- Measuring results independent of the user
- Reliable results even outside of the inspection room



Probe contact with the motorized measuring carriage.



- Temperature compensation with an integrated temperature sensor



Versatile

The Height Measuring Instrument Digimar 816 CL offers numerous practical measuring and evaluation functions:

- Convenient standard measuring functions
- Dynamic measuring functions

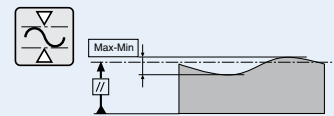

Parallel deviation

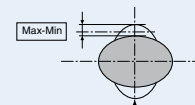

Roundness deviation

- Wide range of options for data evaluation



The measuring program. . .

. . . is essential for repetitive component measurement



- Repetitive measuring procedures can easily be automated
- Simply create a measuring program with the Teach-In-mode
- Complex procedures can be started by just pressing one key

Height Measuring Instrument Digimar 816 CL

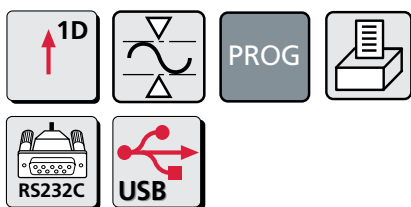

Features

Measuring system

- Excellent accuracy and reliability due to the optical incremental measurement system with the double reader head
- Dynamic probing system enabling high repeatability
- Air bearings system for light and smooth movement
- Precise measuring head on stainless steel guideways
- Motorized measuring carriage simplifies measurement runs
- Temperature compensation with an integrated temperature sensor
- Probe constant remains after the instrument is switched off
- Integrated rechargeable battery with a long operating time for mains independent measurement

Operating and display unit

- Easy to read background lit graphic LCD display
- Large and clearly defined function keys
- Operator guidance with self-explanatory icons / pictograms
- Possible to set additional zero points on a work piece
- Memory can store up to 99 measured values
- MarConnect data output, select either:
 - USB
 - OPTO RS232C
- Supplied with:
 - Height Measuring Instrument incl. operating and display unit,
 - Carrier 817h1, Probe K6/51, Setting block 817 eb, Operating instructions, Mains power adapter and a Calibration certificate

Technical Data

Measuring range	mm / <i>inch</i>	350 / 14"	600 / 24"
Range of application	mm / <i>inch</i>	540 / 21.26"	770 / 30.31"
Resolution	mm (<i>inch</i>)	0.01 / 0.001 (.0001" / .00005")	
Measuring error*	μm	(2.8+L/300), L in mm	
Repeatability	μm	2 (plane) 3 (bore)	
Perpendicularity error (mech.)	μm	frontal ≤15	frontal ≤20
Operating time of rechargeable battery	h	up to 14	
Measuring force	N	1.0 ± 0.2	
Permissible relative air humidity	%	65 (non condensed)	
Working temperature	°C / °F	20 ±1 / 68 ±1.8	
Operating temperature	°C / °F	10 ... 40 / 50 ... 104	
3-point air cushion, height	μm	ca. 9	
Measuring system		incremental scale with optical reading	
Total height	mm / <i>inch</i>	741 / 29.17"	985 / 38.78"
Base area (L x W)	mm / <i>inch</i>	240 x 250 / 9.45" x 9.84"	
Weight	kg / lbs	25 / 55.15	30 / 66.14
Order no.		4429030	4429031

* 20°C with surface base plate according to DIN 876/0 and standard probe K6/51

Overview of carriers and probes for Digimar 817 CLM / 816 CL

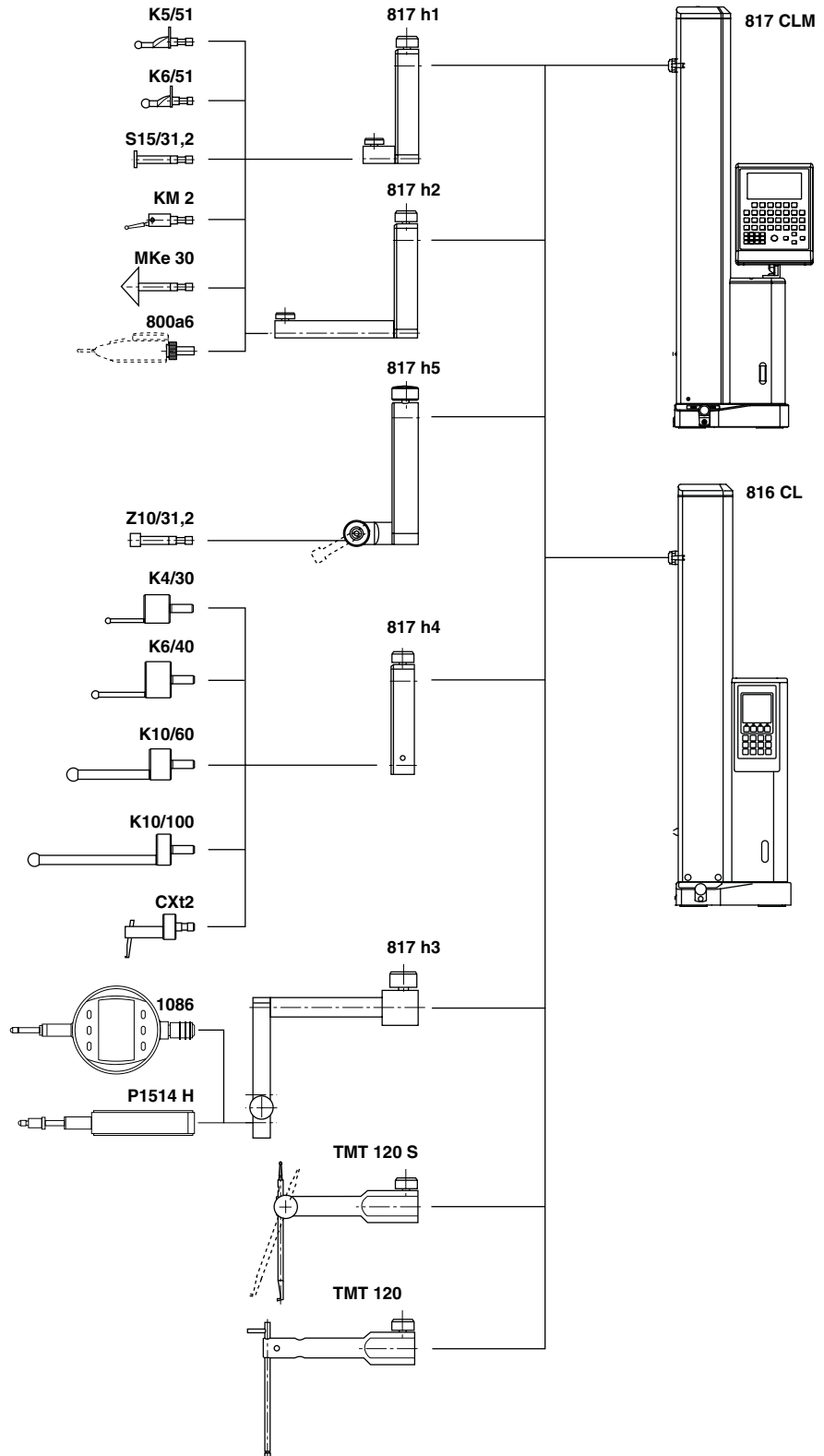

Height Measuring Instruments Digimar 817 CLM / 816 CL

Accessories

Carrier for probes with mount dia. 6 mm

Catalog no.	Description	Shaft length mm	Order no.
817 h1	Carrier for a probe	27.5	4429154*
817 h2	Carrier for a probe	100	4429219
817 h5	Carrier with a joint for a probe	35	4429454

* Supplied with standard accessories

817 h1

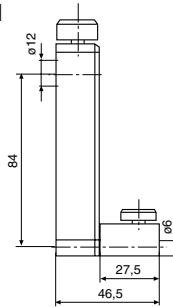

817 h2

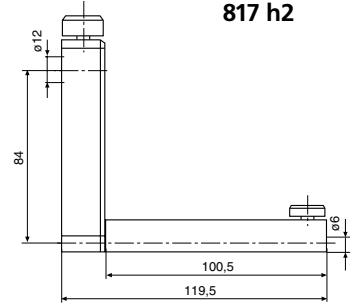

817 h5

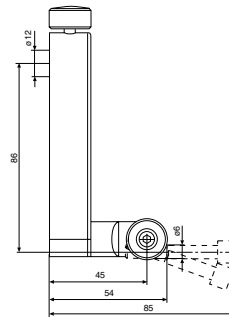

rotatable

Probes with mount dia. 6 mm

Catalog no.	Description	Order no.
K5/51	Spherical probe	4429158
K6/51	Spherical probe	4429254*
S15/31,2	Disc probe	4429226
Z10/31,2	Cylindrical probe	4429227
MKe 30	Taper probe	4429228
KM 2	Probe M2 incl. styli 800 ts, dia. 2 mm	4429256
800 a6	Mounting shaft 800 a6 for MarTest	4301865

* Supplied with standard accessories

K 5/51

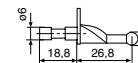

K 6/51

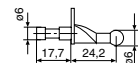

S 15/31,2

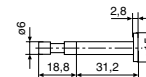

MKe 30

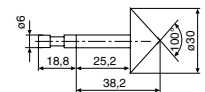

Z 10/31,2

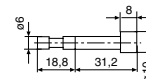

KM 2

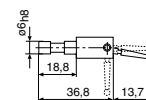

800 a6

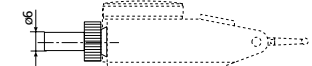

Height Measuring Instruments Digimar 817 CLM / 816 CL

Accessories

Carrier for probes with mount dia. 8 mm

Catalog no.	Description	Order no.
817 h4	Carrier for probes	4429220

817 h4

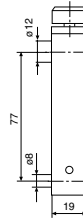

Probes with mount dia. 8 mm

Catalog no.	Ball dia. D mm	Order no.
K4/30	4	7023813
K6/40	6	7023816
K10/60	10	7023810
K10/100	10	7023615

K 6/40

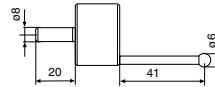

K 4/30

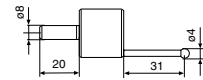

K 10/60

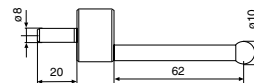

K 10/100

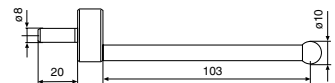

Universal probe CXt2 see page 2-14
The above Probes requires the Probe Carrier 4429220 in order to be used on either an 817 CLM or 816 CL

Depth probes

Catalog no.	Description	Order no.
TMT 120	Depth probe incl. carrier	4429221
TMT 120 S	2 depth probes incl. carrier (rotatable)	4429421

TMT 120

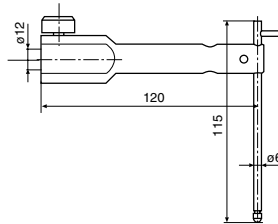

TMT 120 S

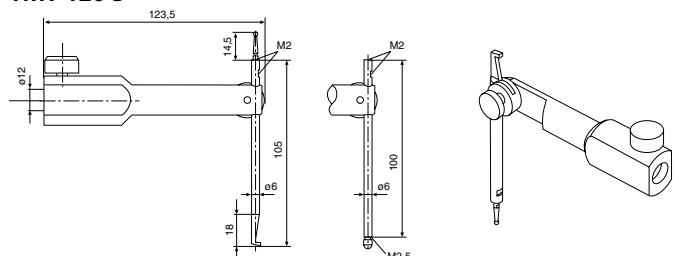

Height Measuring Instruments Digimar 817 CLM / 816 CL

Accessories for checking perpendicularity

Carrier for probes

Catalog no.	Description	Order no.	817 h3
817 h3	Carrier for transducers	4429206	

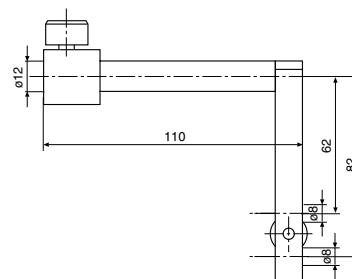

Transducers for checking perpendicularity

Catalog no.	Description	Order no.
P1514 H	Incremental probe, 12 mm incl. cable	4426810*
1086 R	Digital indicator, 12.5 mm Resolution 0.001 mm** / .00005"	4337620
16 EXr	Data cable for Digital indicator 1086 R	4102410*

* Only for Digimar 817 CLM

** Resolution switchable

817 h3

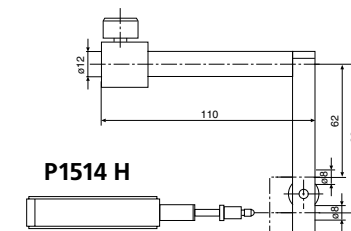

P1514 H

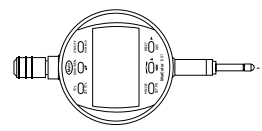

1086 R

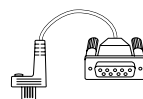

16 EXr

Accessories

Setting blocks

Catalog no.	Description	Order no.	817 eb
817 eb	Setting block	4429168*	

* Supplied with standard accessories



Height Measuring Instruments Digimar 817 CLM / 816 CL

Accessory sets for probes

Probe set 817 ts1 consists of:	4429019
Carrying case for accessories	4429020
817 h2 Carrier for probes	4429219
S15/31,2 Disc probe	4429226
Z10/31,2 Cylindrical probe	4429227
MKe 30 Taper probe	4429228
TMT 120 Depth probe incl. carrier	4429221
KM 2 Probe for MarTest styli M2	4429256
817 h4 Carrier for probes	4429220
K4/30 Spherical probe	7023813
K6/40 Spherical probe	7023816
K10/60 Spherical probe	7023810
K10/100 Spherical probe	7023615

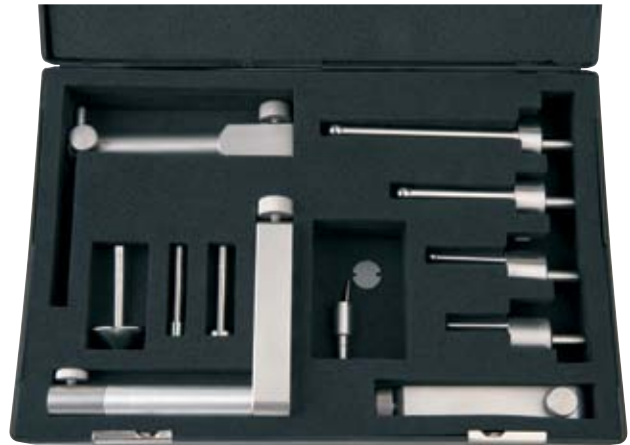

817 ts1

Probe set 817 ts2 consists of:	4429018
Carrying case for accessories	4429020
817 h2 Carrier for probes	4429219
S15/31,2 Disc probe	4429226
Z10/31,2 Cylindrical probe	4429227
MKe 30 Taper probe	4429228
TMT 120 Depth probe incl. carrier	4429221
KM 2 Probe for MarTest styli M2	4429256

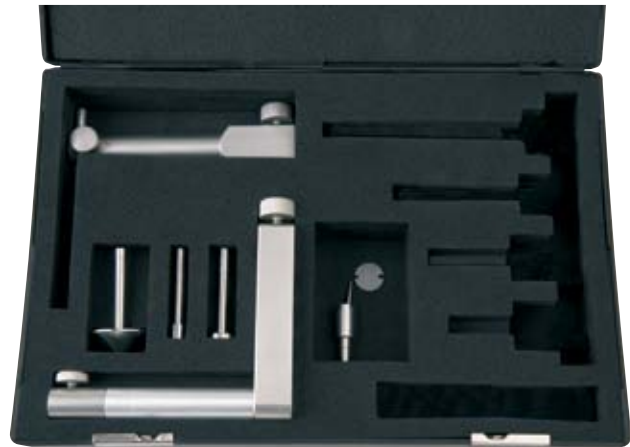

817 ts2

Universal probe set CXt2 consists of:	7034000
Case	3015925
Probe carrier	3015917
Measuring crook	3015918
Probe pin /tip:	3015919
Taper probe	3015920
Spherical probe	3022000
Spherical probe	3022001
Spherical probe	3022002
Extension M3 – M3	3015921
Extension M3 – M2.5	3015888

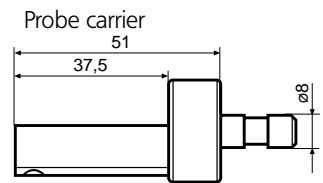

Measuring crook

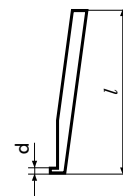

Pin probe

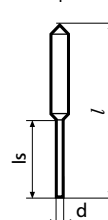

Taper probe

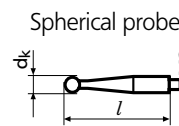
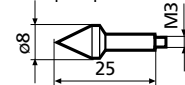

Extension

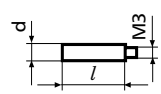

The above Probes requires the Probe Carrier 4429220 in order to be used on either an 817 CLM or 816 CL

Height Measuring Instruments Digimar 817 CLM / 816 CL

Accessories for data transmission for 816 CL

Data connection cable

		Order no.
Data connection cable incl. MarCom Standard, USB (2 m)	2000 usb	4346023
Data connection cable Opto RS232C (2 m), with SUB-D jack 9-pin	2000 r	4346020

Accessories for Data Processing see Chapter 11

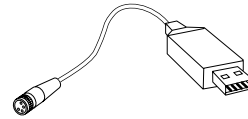

4346023

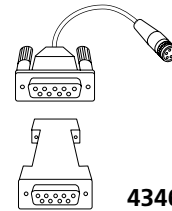

4346020

Accessories for data transmission for 817 CLM

Data connection cable

		Order no.
Data cable 817 CLM to a PC		7024634
Adapter cable RS232-USB for Digimar 817 CLM incl. MarCom Standard		4102333

Accessories for Data Processing see Chapter 11

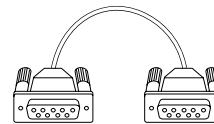

7024634

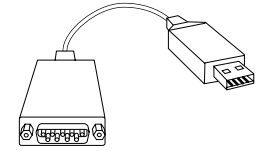

4102333

Printer for 817 CLM

HP Officejet printer

- Standard connectivity: USB - compatible with USB 2.0 specifications
- Compatible operating systems: Microsoft® Windows® 98 SE, Me, 2000, XP, 7, 8
- Standard printer languages HP PCL 3



Similar to illustration

	Order no.
HP Officejet printer	4429015

Height Measuring and Scribing Instrument Digimar 814 N Standard version



Applications

Ideal for measuring:

- Heights
- Center distances between bores and surfaces, widths of ledges, plus marking and scribing of workpieces

Features

With extra rugged, cast iron base with three-point support. To be used on base plates, machine beds and work piece surfaces. Conversion to a 814 G version is quick and easy at any time.

- High accuracy
- Incremental inductive measuring system
- Measuring head with an ball bush guide
- Resistance free measuring system
- Large, easy to read digital display
- Measuring and display unit are incorporated in the measuring head
- Easy to operate due to the hand crank on the side of the measuring head
- Constant measuring force; acting upwards or downwards as required
- Measuring head can be locked in position, ideal for scribing tasks
- With fine adjustment
- Data transmission via Opto RS232C interface
- Digital Preset
- Zero setting in any position
- MAX, MIN and MAX-MIN functions
- Enter tolerance limit for 1 characteristic
- Switch between mm/inch
- Mains independent due to being battery operated
- Universal application due to a broad range of accessories

Technical Data

Measuring range	mm / <i>inch</i>	320 / 12.6"	620 / 24.4"
Resolution	mm (<i>inch</i>)	0.01 / 0.001 (.0005" / .00005")	
Measuring error	µm	20 / .0008"	30 / .0012"
Repeatability	µm		5 / .0002"
Perpendicularity error	µm	frontal 20 (300 mm)	frontal 30 (600 mm)
Operating time of the battery	h		2000
Measuring force	N		ca. 3
Working temperature	°C / °F		20 ±1 / 68 ±1.8
Operating temperature	°C / °F		5... 40 / 41...104
Measuring system			inductive
Total height	mm / <i>inch</i>	513 / 20.20"	813 / 32.01"
Cast iron base (L x W)	mm / <i>inch</i>	205 x 175 / 8.07" x 6.89"	205 x 175 / 8.07" x 6.89"
Weight	kg / lbs	6.2 / 13.22	10.5 / 23.15
Order no.		4426540	4426542

Height Measuring and Scribing Instrument Digimar 814 G Base plate version



Applications

Ideal for measuring:

- Heights
- Center distances between bores and surfaces, widths of ledges, plus marking and scribing of workpieces

Features

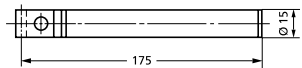
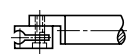
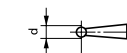
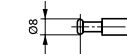
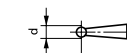
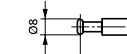
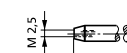

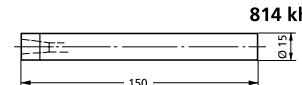
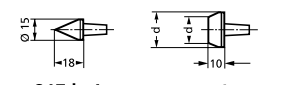
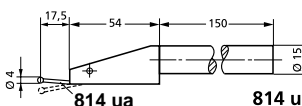
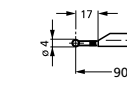
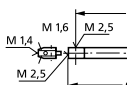
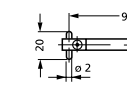
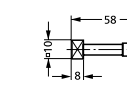

Table plate is made of fine grained black granite (greenstone) which is extremely hard and stable.
Conversion to a 814 N version is quick and easy at any time.

- High accuracy
- Incremental inductive measuring system
- Measuring head with an ball bush guide
- Resistance free measuring system
- Large, easy to read digital display
- Measuring and display unit are incorporated in the measuring head
- Easy to operate due to the hand crank on the side of the measuring head
- Constant measuring force; acting upwards or downwards as required
- Measuring head can be locked in position, ideal for scribing tasks
- With fine adjustment
- Data transmission via Opto RS232C interface
- Digital Preset
- Zero setting in any position
- MAX, MIN and MAX-MIN functions
- Enter tolerance limit for 1 characteristic
- Switch between mm/inch
- Mains independent due to being battery operated
- Universal application due to a broad range of accessories

Technical Data

Measuring range	mm / <i>inch</i>	320 / 12.6"	620 / 24.4"
Resolution	mm (<i>inch</i>)	0.01 / 0.001 (.0005" / .00005")	
Measuring error	μm	20 / .0008"	30 / 0.0012"
Repeatability	μm		5 / .0002"
Perpendicularity error	μm	frontal 20 (300 mm)	frontal 30 (600 mm)
Operating time of the battery	h		2000
Measuring force	N		ca. 3
Working temperature	°C / °F		20 ±1 / 68 ±1.8
Operating temperature	°C / °F		5... 40 / 41...104
Measuring system			inductive
Total height	mm / <i>inch</i>	558 / 21.97"	858 / 33.78"
Granite plate (L x W)	mm / <i>inch</i>		200 x 300 / 7.87" x 11.81"
Grade of accuracy			1 DIN 876
Weight	kg / lbs	14 / 30.86	18.3 / 35.27
Order no.		4426541	4426543

Accessories for Height Measuring and Scribing Instrument Digimar 814 N / 814 G

		Order no.	
814 t	Probe arm with joint for mounting probes, dial indicators, dial comparators and test indicators. Length of mounting shank 150 mm (.591") Mounting bore 8 mm (.315")	4426510*	
814 m	Spherical probe To mount in probe arm 814 t	(.0787") 4426525 (.118") 4426526 (.157") 4426512 (.197") 4426527 (.236") 4426511 (.276") 4426528 (.315") 4426509*	  
814 s	Disc probe for measuring heights, distances, surfaces and edges. Especially recommended for narrow shoulders, e.g. on centering edges.	4426513	
814 h	Probe holder M 2.5 to mount the styli of dial indicators and dial comparators. For special applications.	4426514	
814 a	Scriber for scribing and marking of work pieces. Carbide tipped. To be mounted on the Probe arm 814 t.	4426515	
814 kh	Halter	4426516	
817 ks1	Measuring taper 0 – 15 (0 - .591")	4426071	
817 ks2	Measuring taper 14 – 20 (.551" - .787")	4426072	
817 ks3	Measuring taper 18 – 24 (.709" - .945")	4426073	
817 ks4	Measuring taper 23 – 30 (.906" - 1.181")	4426074	
814 u	Two direction probe 4 mm ball (.157") for measuring outside and inside diameters, width of ledges, recesses and slots. Actual ball diameter does not influence the results.	4426517	
814 ua	Interchangeable probe arm 2 mm ball (.0787") for use in conjunction with the two direction probe 814 u	4426518	
817 Cl-r	Spherical probe 4 mm ruby ball (.157")	4426498	
817 Cl-am	Holder with connection thread M 2.5, M 1.6, M 1.4	4426434	
817 Cl-sa	Stylus with exchangeable measuring pin	4426433	
817 Cl-p	Stylus with parallel measuring faces Battery 3 V, type CR 2032	4426435 4102520*	
	Dust cover 0–320 mm (0 - 12.60")	4426616*	
	Dust cover 0–620 mm (0 - 24.41")	4426619*	
814 Nf	Cast iron base	4426506**	
814 Gf	Table plate	4426507**	
814 X	Column with measuring head 0–320 mm (0 - 12.60")	4426544	
814 X	Column with measuring head 0–620 mm (0 - 24.41")	4426545	
16 ESv	Data connection cable Opto RS232C Length 2 m (6.56 ft)	4102510	

* Scope of supply
** for upgrade

Height Measuring and Scribing Instrument Digimar 814 SR



REFERENCE

Application

- Scribing and marking of work pieces
- Measuring heights and distances



Features

Functions:

- RESET (Set the display to zero for relative measurement)
- ABS (Switch between relative and absolute measurement) mm/inch
- Reference-Lock/Unlock
- PRESET (To enter a numerical value)
- DATA (Data transmission via connection cable)
- Auto-ON/OFF
- Life of the battery up to 3 years
- Max. measuring speed 1.5 m/s (60"/s)
- MarConnect Data output: choose either
USB
OPTO RS232C
Digimatic

- High contrast Liquid Crystal Display with 12 mm high digits
- Sturdy heavy-duty base, easy to handle
- Hardened and lapped contact surface which produce both a smooth and even movement
- Slide and beam made of hardened stainless steel
- Hand crank for positioning and measuring
- Fine adjustment
- Locking screw
- Interchangeable scriber point, carbide tipped
- Scope of supply: Scriber point, cardboard box, battery and operating instructions

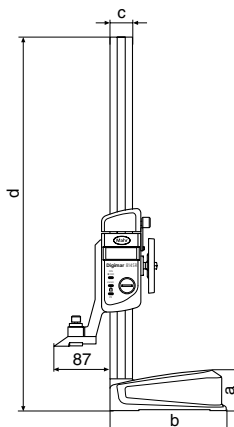

Dimensions

mm	a	b	c	d
350	62	180 x 98	35 x 15	580
600	62	180 x 98	35 x 15	835

Technical Data

Measuring range		Resolution	Error limit	Weight	Order no.
mm	(inch)	mm / inch	mm / inch	kg / lbs	
350	(14")	0.01 / .0005"	0.04 / .0016"	7 / 15.43	4426100
600	(24")	0.01 / .0005"	0.05 / .0020"	8 / 17.64	4426101

Accessories

	Order no.
Measuring / Scriber Point, carbide tipped	814 SRs 4123867
Holder for Test Indicators	27 Sp 4123041
Battery 3V, type CR 2032	4102520
Data Connection Cable USB (2 m)	16 EXu 4102357
Data Connection Cable Opto RS232C (2 m), with SUB-D jack 9-pin	16 EXr 4102410
Data Connection Cable Digimatic (2 m), Flat plug 10-pin	16 EWd 4102915

27 Sp

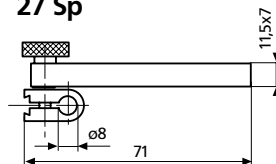

814 SRs

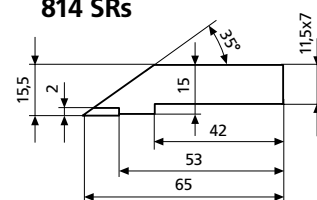

WWW.MAHR.COM

- 0 +

Mahr

E X A C T L Y



آزما صنعت گراد

تست و اندازه گیری . تجهیزات . مشاوره

Unit 3 - 2ndfloor- No.24 West Shahid Ghandi St.
North Sohrevardi Ave. Tehran . Iran
Tel : +98 21 88745209 , 86030765
Fax: +98 21 88764890

تهران - خیابان سهروردی شمالی - خیابان شهید قندی غربی
پلاک ۲۴ - ورودی غربی - طبقه دوم - واحد ۳
تلفن : ۸۶۰۳۰۷۶۵ ، ۸۸۷۴۵۲۰۹
فاکس : ۸۸۷۶۴۸۹۰

www.asgradco.com info@asgradco.com